



Flight-Training
30.03.2021
ROSTER



PKG 1976
KUNSAN AB, F-16CM-52, Training

TO: 09:30LT 
ARR: approx. 11:00LT

Beast 6 (TARCAP): Corran, Numsi, Stingray, Kiwi

Viper 3 (SEAD 1): Dro16, Bluebird, Tomahawk, **Joker**

Mudhen 6 (SEAD 2): Opasi, Sneakpeek, **Anvil**

Cyborg 6 (Strike 1): Hunter, Actros, MadMax, TheWitch

Cajun2 (Strike 2): Joe, Cupra, Bflat

PKG 1976: KUNSAN AB, TO: 09:30LT

Beast 6 (TARCAP): South

Viper 3 (SEAD1): North

Mudhen 6 (SEAD2): Süd

Cyborg 6 (Strike1): North

Cajun 2 (Strike2): 2-ship South

Main Focus

WP3-WP4: AAR

WP6: Strike (Bridges, MK-82), SA-3, MiG-23

WP8: Check Arresting System, Check „Hot-Pit“

WP9: ILS-Approach Rwy. Rwy. 36, = Bad Weather Conditions (Rain)

Others:

- RAMP, new Checklists
- Formation
- TIMBER
- YARDSTICK
- Lead change

Anflug zur „Fanghakenlandung“:
Kommunikation auf Flugplatzfrequenz:
„Declaring an Emergency“, anschl. Hot-Pit

Weather Conditions: Hazard „ICING“
FAIR, Temp. +1°C, Wind 290°, 10-15 kts,
Clouds SCT 4/8, 6.000-10.000 ft AGL
BECMG: POOR, Rain, Visibillity <8 km
Wind up to 20 kts, sun set: 18:52LT

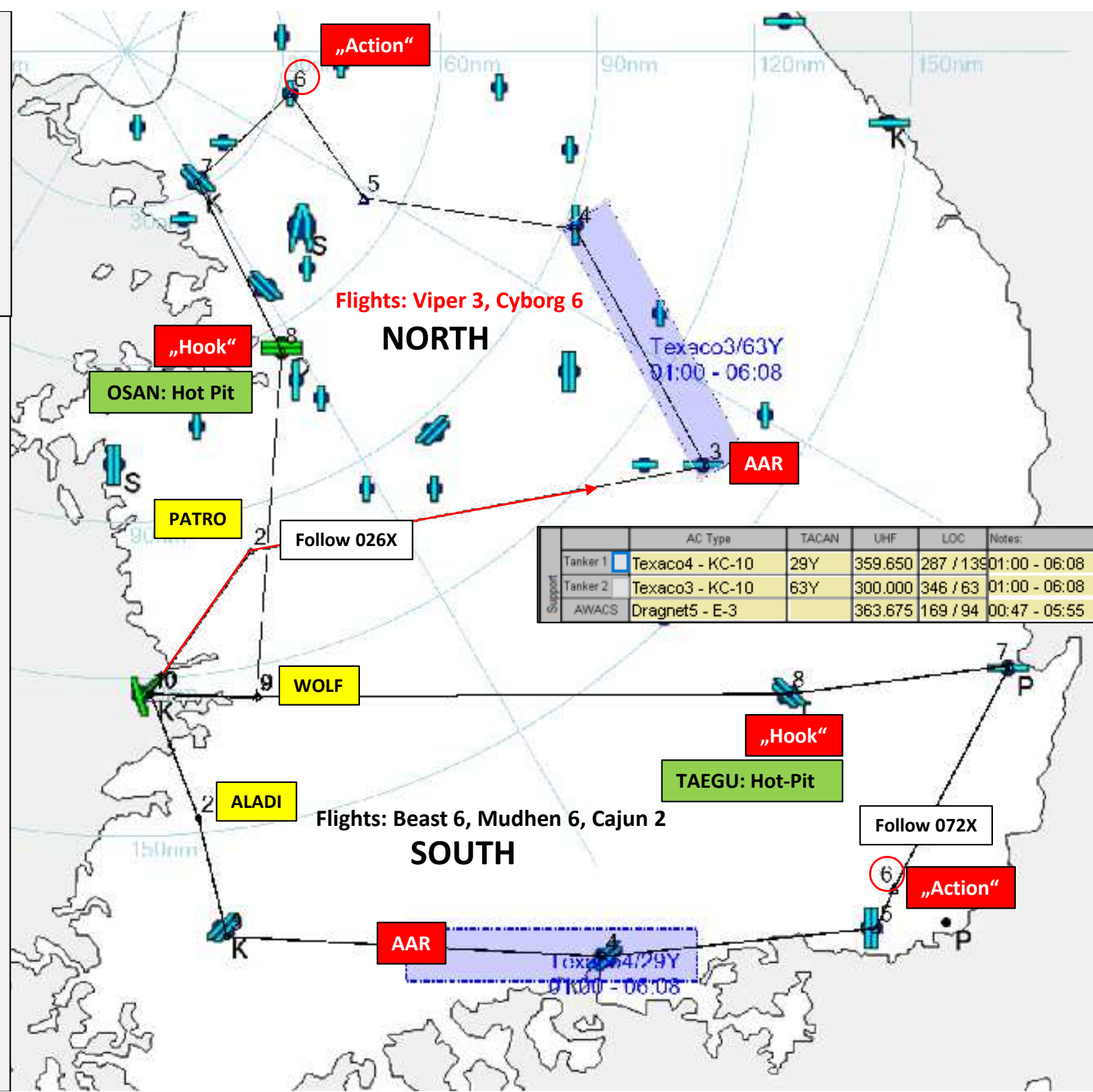

AIRPORT DIAGRAM

Date: 12 Dec 2019

OSAN AB (RKSO)
SOUTH KOREA

| TCN: | ATIS: | GND: | TWR: | APP/DEP: | TA(ft) / TL: | GPS: | ELEV: |
|------|---------|-------|-------|----------|--------------|-----------------------------|-------|
| 94X | 132.125 | 253.7 | 308.8 | 306.3 | 14000/FL140 | N37°04.141' E128°00.881' | 97' |



Draggin's Lair, Diamond A and Flow through will be used for RWYs 09 departure. Exit Draggin's Lair and Diamond A via TWY A is mandatory. Diamond C, Base Ops and Diamond B will be used for RWYs 27 departure. Use taxiway Foxtrot. Contact Osan ATC for the active departure runway.

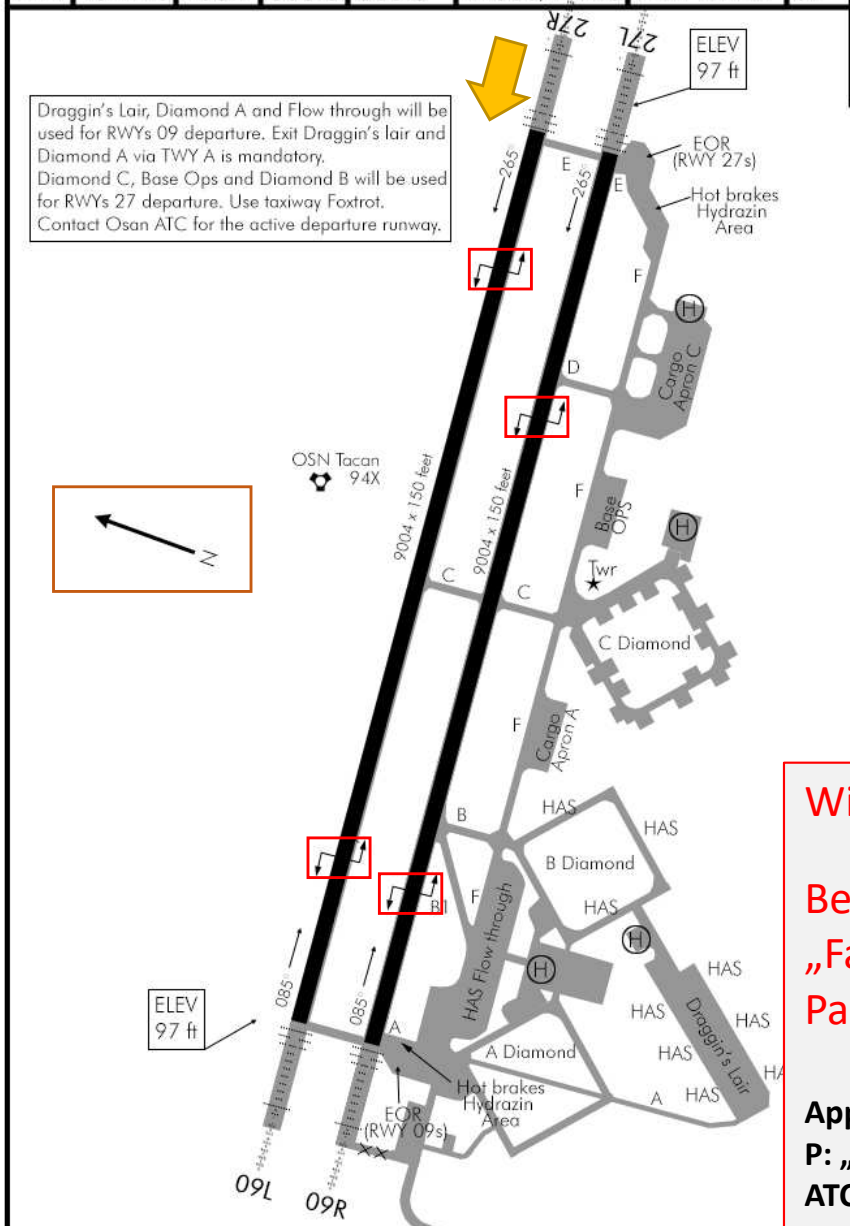

Wind: 290°, 10-15 kts

Beide Runways sind für die „Fankhakenlandung“ im Parallelbetrieb freigegeben!

Approach:
P: „Declaring an Emergency!“
ATC: „You are cleared all the way in!“

AIRPORT DIAGRAM

Date: 12 Dec 2019

TAEJU (RKTN)
SOUTH KOREA

| TCN: | ATIS: | GND: | TWR: | APP/DEP: | TA(ft) / TL: | GPS: | ELEV: |
|------|--------|-------|-------|----------|--------------|-----------------------------|-------|
| 125X | 127.65 | 275.8 | 365.0 | 346.3 | 14000/FL140 | N35°57.916' E129°55.548' | 353' |

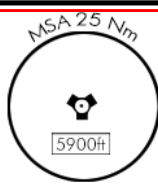

Note:
Contact ATC to activate
RL, REIL, ALS & PAPI.

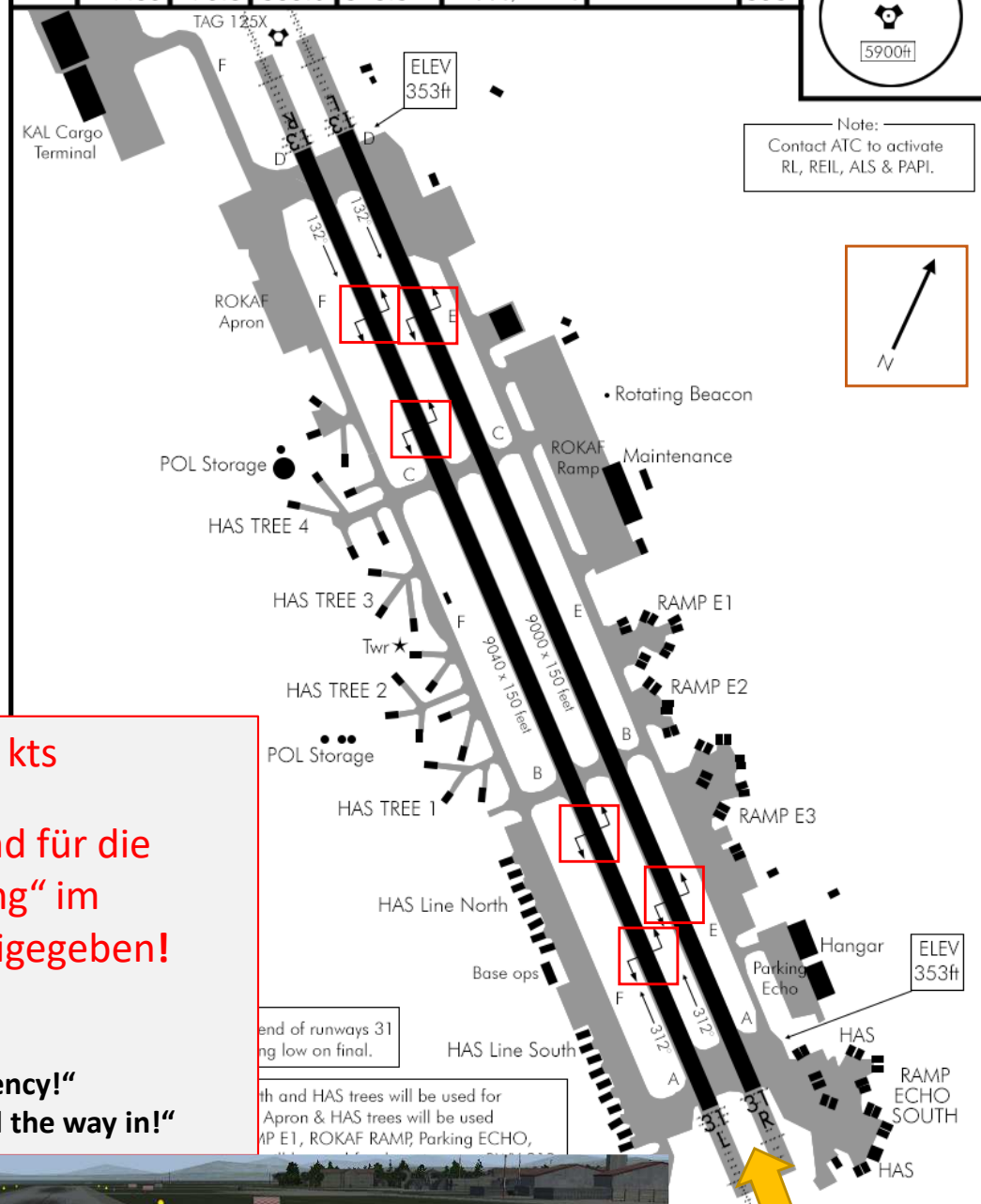

Threat-Analysis

Main Target



SAM Evasion



TF „North“

TF „South“

