



Flight-Training
06.04.2021
ROSTER



PKG 1976
KUNSAN AB, F-16CM-52, Training

TO: 13:00LT (04:00Z)
ARR: approx. 14:30LT (05:30Z)

- Satan 4 (TARCAP):
- Viper 1 (SEAD 1):
- Spade 2 (SEAD 2):
- Mudhen 5 (Strike 1):
- Hawkeye 7 (Strike 2):

- Corran, Stingray
- Dro16, **Bluebird, Joker**
- Opasi, Kiwi
- BadCrow, TheWitch, **Joe**
- Cupra, Actros, **Hunter**



PKG 1976: KUNSAN AB, TO: 13:00LT

Satan 4 (TARCAP): South

Viper 1 (SEAD1): North

Spade 2 (SEAD2): South

Mudhen 5 (Strike1): North

Beast 6 (Strike2): South

Main Focus

WP3-WP4: AAR

WP6: Strike (Bridges, MK-82), SA-3, MiG-23

WP7: Engagement Tu-95 (AIM-9X)

WP8: Check Arresting System, Check „Hot-Pit“

WP9: ILS-Approach Rwy. Rwy. 36,
= Bad Weather Conditions (Rain)

Others:

- RAMP, new Checklists
- Formation
- TIMBER
- YARDSTICK
- Lead change

Anflug zur „Fanghakenlandung“:
Kommunikation auf Flugplatzfrequenz:
„Declaring an Emergency“, anschl. Hot-Pit

Weather Conditions: Hazard „ICING“

FAIR, Temp. +1°C, Wind 290°, 10-15 kts,
Clouds SCT 4/8, 6.000-10.000 ft AGL
BECMG: POOR, Rain, Visibillity <8 km
Wind up to 20 kts, sun set: 18:52LT

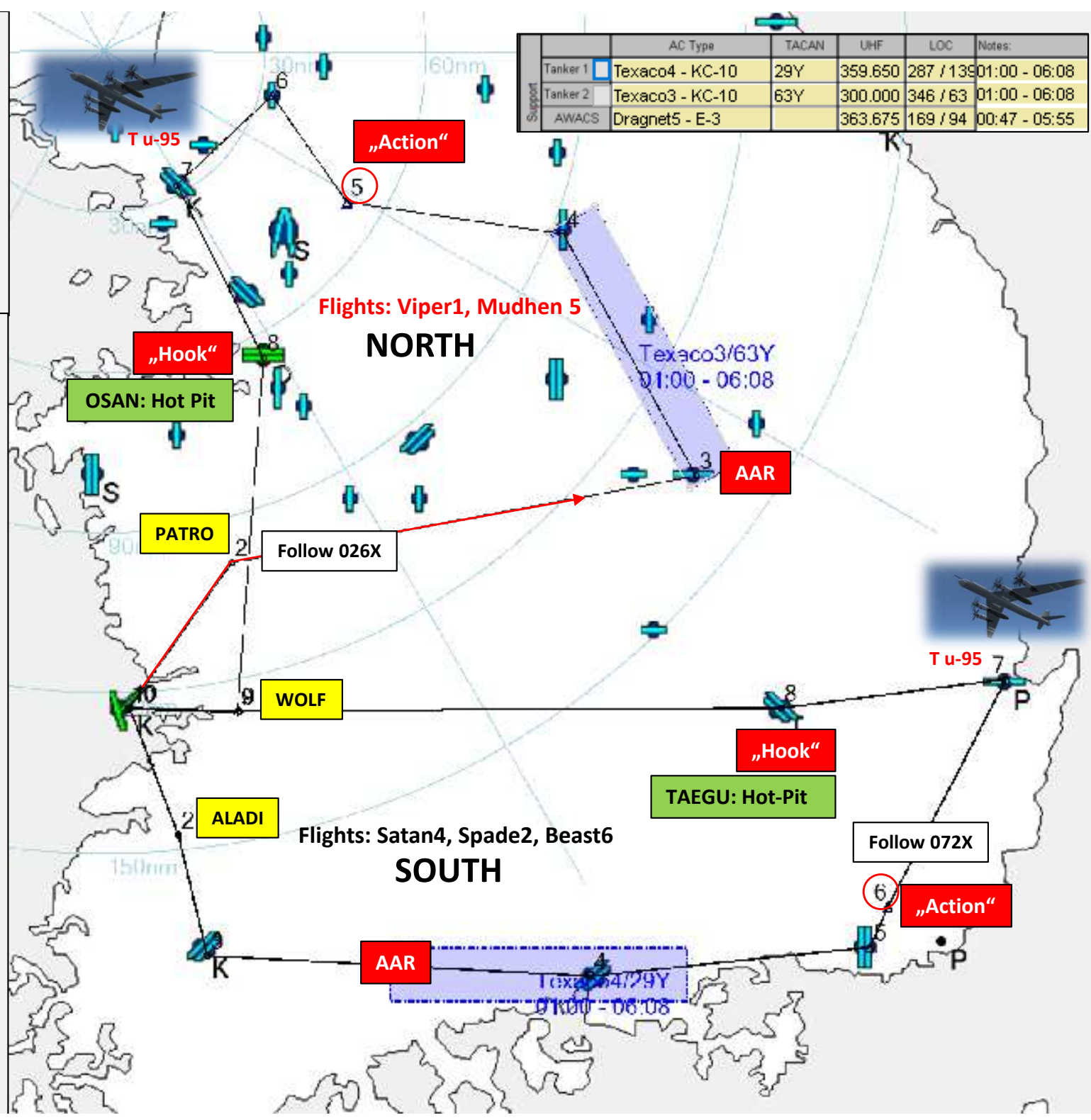

AIRPORT DIAGRAM

Date: 12 Dec 2019

OSAN AB (RKSO)
SOUTH KOREA

TCN:	ATIS:	GND:	TWR:	APP/DEP:	TA(ft) / TL:	GPS:	ELEV:
94X	132.125	253.7	308.8	306.3	14000/FL140	N37°04.141' E128°00.881'	97'

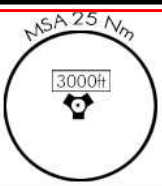

Draggin's Lair, Diamond A and Flow through will be used for RWYs 09 departure. Exit Draggin's Lair and Diamond A via TWY A is mandatory. Diamond C, Base Ops and Diamond B will be used for RWYs 27 departure. Use taxiway Foxtrot. Contact Osan ATC for the active departure runway.

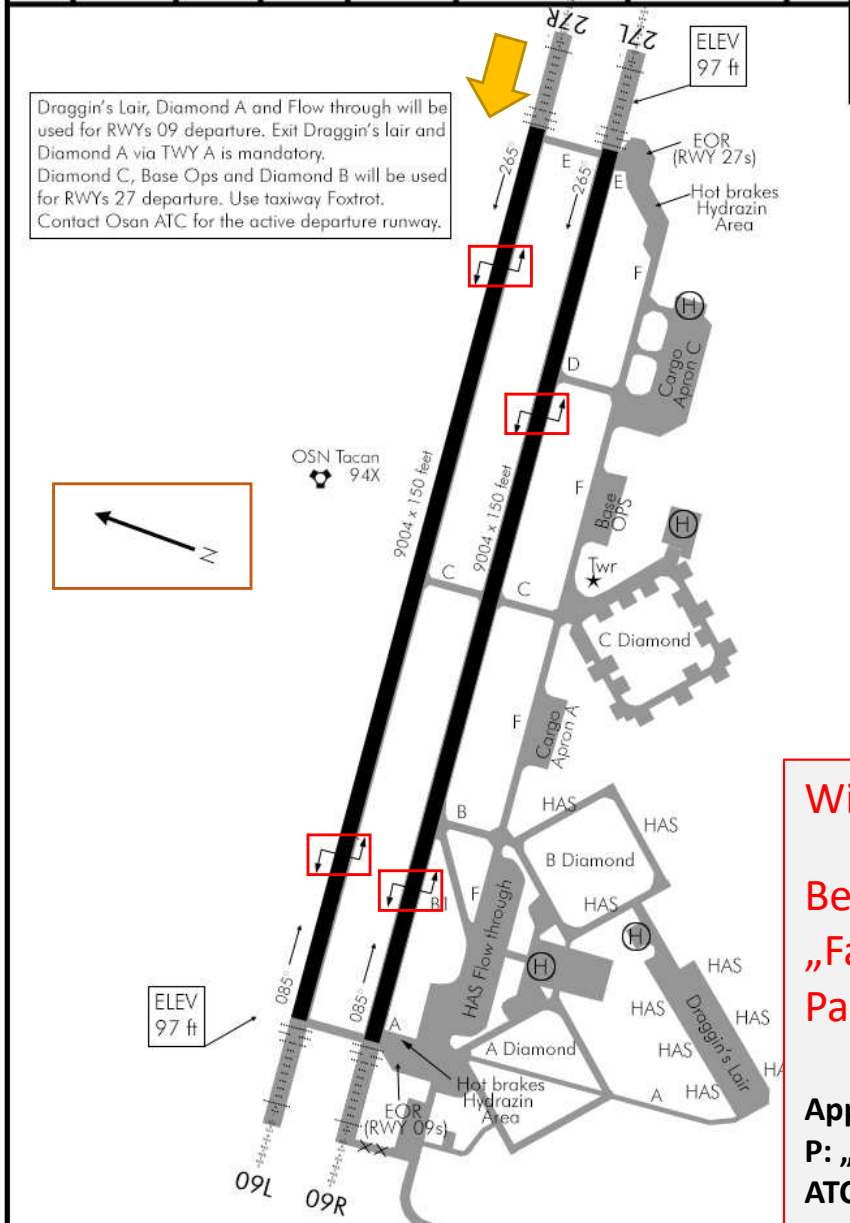

Wind: 290°, 10-15 kts

Beide Runways sind für die „Fankhakenlandung“ im Parallelbetrieb freigegeben!

Approach:
P: „Declaring an Emergency!“
ATC: „You are cleared all the way in!“

AIRPORT DIAGRAM

Date: 12 Dec 2019

TAEJU (RKTN)
SOUTH KOREA

TCN:	ATIS:	GND:	TWR:	APP/DEP:	TA(ft) / TL:	GPS:	ELEV:
125X	127.65	275.8	365.0	346.3	14000/FL140	N35°57.916' E129°55.548'	353'

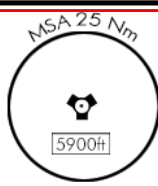

Note:
Contact ATC to activate
RL, REIL, ALS & PAPI.

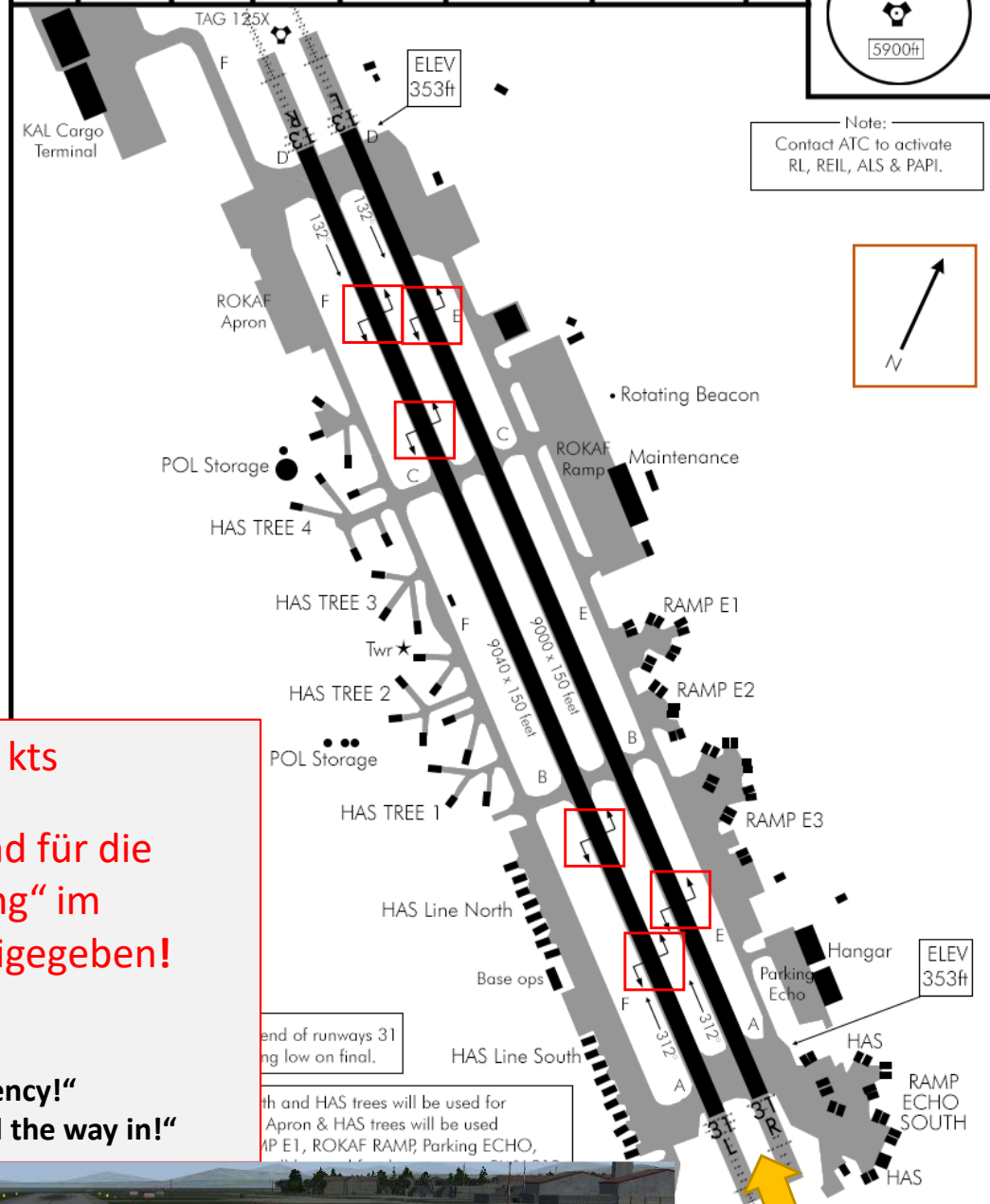

Threat-Analysis

Main Target



SAM Evasion

TF „North“

TF „South“

